



Level 3/302/9 Village Place Kirrawee NSW

1  1  1 

Great opportunity to buy one of Kirrawee's finest and newest apartments in South Village, an iconic development in Sutherland Shire. Conveniently situated only a 180m walk to Kirrawee station, brand new shopping village right at your doorstep with Coles and Aldi supermarkets, eateries & cafes and childcare center. With easy access to the CBD, national parks and Cronulla Beach. South Village offers a unique luxury lifestyle.

This property features:

- This unit boasts a fantastic city view
- Large modern style kitchen
- Generous open plan design, abundance of natural light
- Bathroom has floor to ceiling tiles
- Spacious bedroom, built-in wardrobes
- Internal laundry with dryer
- Security parking

Building Size : 64 sqm
View

: <https://www.hualei.com.au/sale/nsw/sutherland/kirrawee/residential/apartment/5826260>



Steven (Xuhua) HOU
 0424 168 198



HUALEI Sales
 (02) 9299 5402

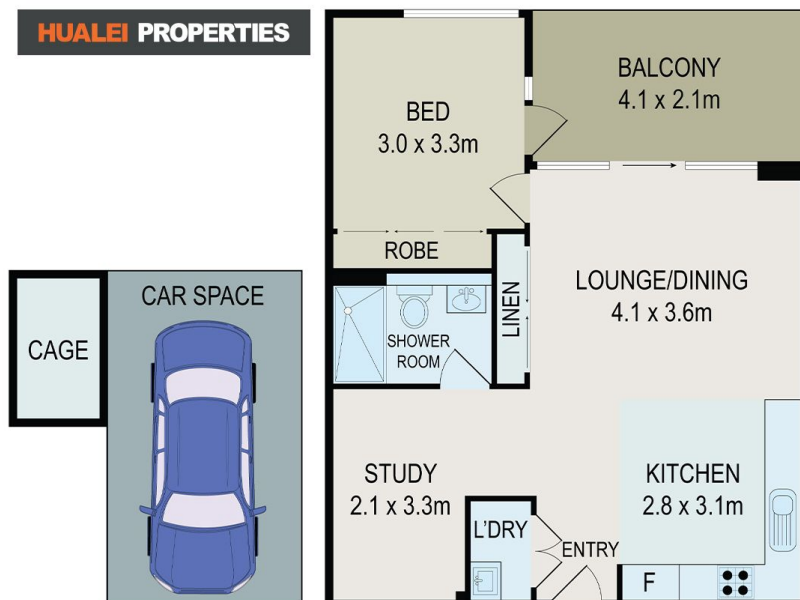

0 1 2 3 4 5

All information contained herein is gathered from all sources we believe to be reliable. However we cannot guarantee its accuracy and interested parties should rely on their own enquiries.

