



6a Barclay Close Pymble NSW

4  2  1 

This large 4 bedrooms split level property is well placed in a tranquil cul de sac only minutes drive to Pymble station and a whole host of amenities such as cafes, restaurants, and shops. Not to mention being placed in an enviable school catchment.

Features Include:

- Open plan living design leading to your incredibly large balcony and stunning yard
- Contemporary finished, but classically styled Kitchen with black stone benchtops
- Internal Laundry
- 2 full bathrooms with a water closet on the main living floor
- 4 Large Bedrooms, 3 with built ins, main w/ ensuite
- Under home storage

View : <https://www.hualei.com.au/lease/nsw/north-shore-upper/pymble/residential/semi-detached/5826488>



Sabrina (Lei) LIU
 0405 551 689



HUALEI Rental
 (02) 9299 5402

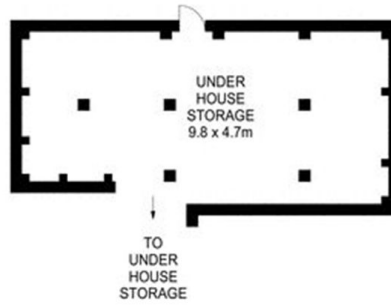
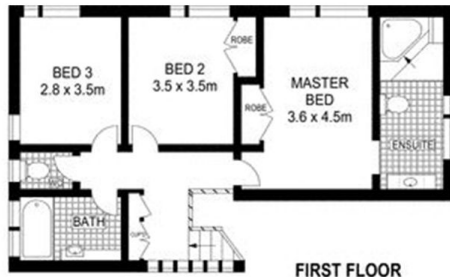

Scale in metres. Indicative only. Dimensions are approximate. All information contained herein is gathered from sources we believe to be reliable. However we cannot guarantee its accuracy and interested persons should rely on their own enquiries.

6A Barclay Close, Pymble

HUALEI PROPERTIES