



### 301/8 Nuvolari Place Wentworth Point NSW

2  2  1 

Well maintained and as new 2-bedroom apartment situate in Wentworth Point Piazza.

Walking distance to Library, transportation, community Piazza shops, Café, and restaurants.

Public transport and ferry service to Parramatta and CBD.

Moments to Sydney Olympic Park main venues, Bicentennial Park and Millennium Parklands.

Pulse Club offer access to the local gym, indoor lap pool, outdoor lagoon pool, steam room and two tennis courts.

Great opportunity for own living and investment.

Featuring:

- Lounge and dining flowing out to a covered entertainers balcony
- Open plan lounge and dining area with quality carpet throughout
- Quality European Caesar Stone kitchen appliance with

**Price** : Vacant position Call for inspection

**View** : <https://www.hualei.com.au/sale/nsw/inner-west/wentworth-point/residential/apartment/7252161>



**Jan (Qi) ZHOU**  
 0403 611 359



**HUALEI Sales**  
 (02) 9299 5402

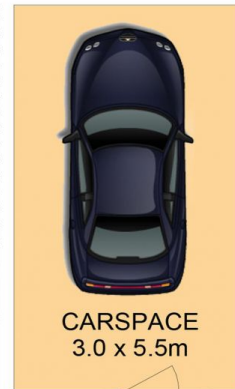
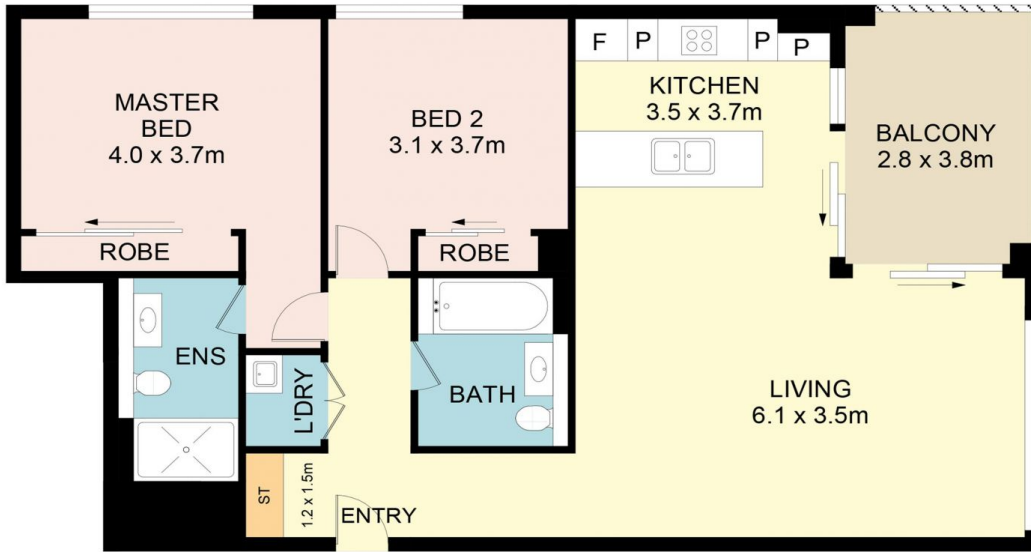

CARSPACE  
3.0 x 5.5m

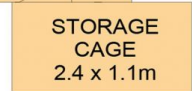

STORAGE  
CAGE  
2.4 x 1.1m

### 301/8 Nuvolari Place, Wentworth Point

DISCLAIMER: No liability for the accuracy of details contained within our floor plans. All plans are drawn and also checked to the best of our ability, however information contained in our floor plans such as area calculations are approximate, and have not been surveyed or drawn to scale. Our floor plans are for representational purposes only and should be used as such. Do not attempt to refer to our floor plans for structural or detailed information.

